

4

3

2

1

WIRING SCHEMATIC

P1		P2	
1	○ 24 AWG RED	○ 1	
2	○ 28 AWG WHITE	○ 2	
3	○ 28 AWG GREEN	○ 3	
4	○ 24 AWG BLACK	○ 4	



THIS PRODUCT CONTAINS PROPRIETARY INFORMATION OF OCP GROUP, INC. AND IS SUBJECT TO THE CONDITIONS THAT THE INFORMATION: (A) BE RETAINED IN CONFIDENCE. (B) NOT BE REPRODUCED OR COPIED IN WHOLE OR IN PART. (C) NOT BE USED INCORPORATED IN ANY PRODUCT EXCEPT ON AN EXPRESS WRITTEN AGREEMENT WITH OCP GROUP, INC.

REVISIONS

DATE	REV	AREA	DESCRIPTION	APP'D
08/09	A	-	INITIAL RELEASE	CJG

RECOMMENDED PANEL CUTOUT

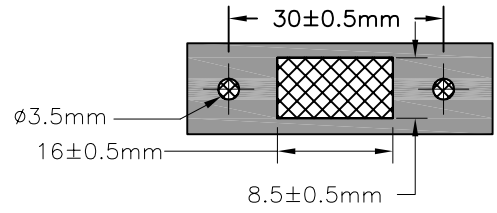

LENGTH TABLE

PART NO.	LENGTH
62-00188-01	1FT±0.5INCH
62-00188-02	2FT±1INCH
62-00188-03	3FT±1INCH
62-00188-06	6FT±2INCHES

SEE LENGTH TABLE

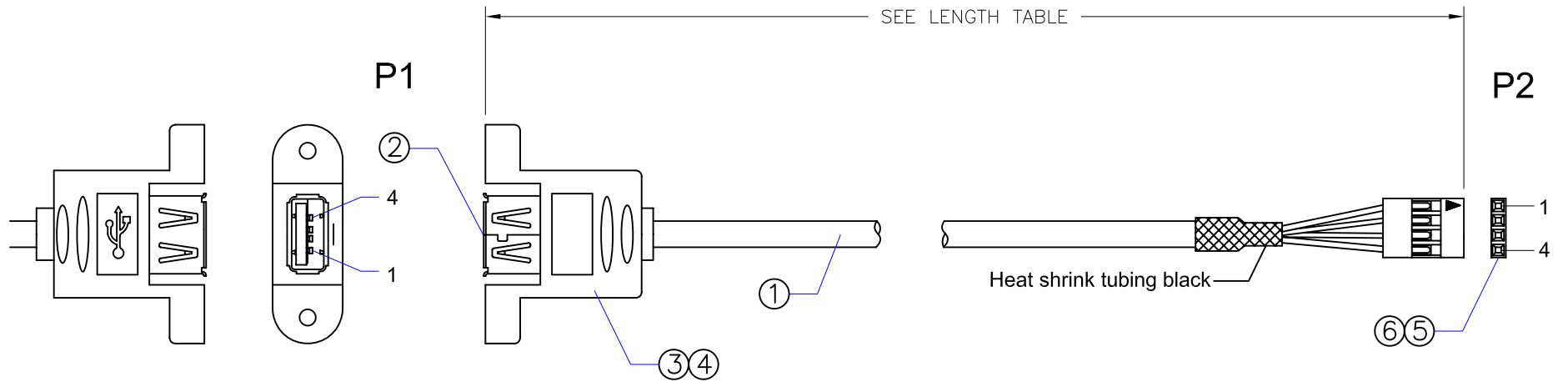

7			UNLESS OTHERWISE SPECIFIED
6			CABLE TOLERANCE
5			LENGTH +/- 3%
4	NUT AND SCREW IN POLYBAG	2	
3	4 PIN CONNECTOR, AND GOLD FLASH CONTACTS	1	CONNECTOR TOLERANCE
2	CONNECTOR: USB "A" FEMALE PANEL MOUNT	1	
1	USB 2.0 CABLE UL 2725 TWISTED PAIR + 2 CONDUCTORS	A/R	
ITEM	DESCRIPTION/REMARKS	QTY	

.XXX±	LINEAR
.XX±	LINEAR

SCALE: NTS DATE: 08/31/09
 UNITS: INCH CHK'D: CJG
 DRAWN BY: EFC APP'D: CJG

TITLE: USB TO MOTHERBOARD TO 4 PIN SLOT PANEL MOUNT			
OCP PART NO.: 62-00188-XX			
CUSTOMER: TBD			
SIZE	DRAWING NUMBER:	REV	SHEET
A	62-00188-XX	A	1/1

4

3

2

1