

WIRE SCHEMATIC

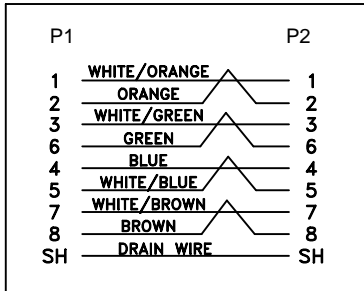

RECOMMENDED PANEL CUTOUT

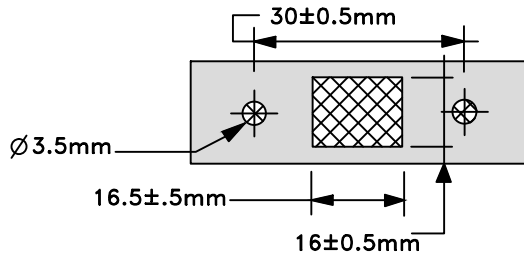

THIS PRODUCT CONTAINS PROPRIETARY INFORMATION OF OCP GROUP, INC. AND IS SUBJECT TO THE CONDITIONS THAT THE INFORMATION: (A) BE RETAINED IN CONFIDENCE. (B) NOT BE REPRODUCED OR COPIED IN WHOLE OR IN PART. (C) NOT BE USED INCORPORATED IN ANY PRODUCT EXCEPT ON AN EXPRESS WRITTEN AGREEMENT WITH OCP GROUP, INC.

REVISIONS

REV	ECN	AREA	DESCRIPTION	APP'D
A	-	-	INITIAL RELEASE	CJG

LENGTH TABLE

PAERT NO.	LENGTH
52-66001-7	1FT ± 1.0 IN
52-66002-7	2FT ± 1.0 IN
52-66003-7	3FT ± 2.0 IN
52-66004-7	4FT ± 2.0 IN
52-66006-7	6FT ± 2.0 IN

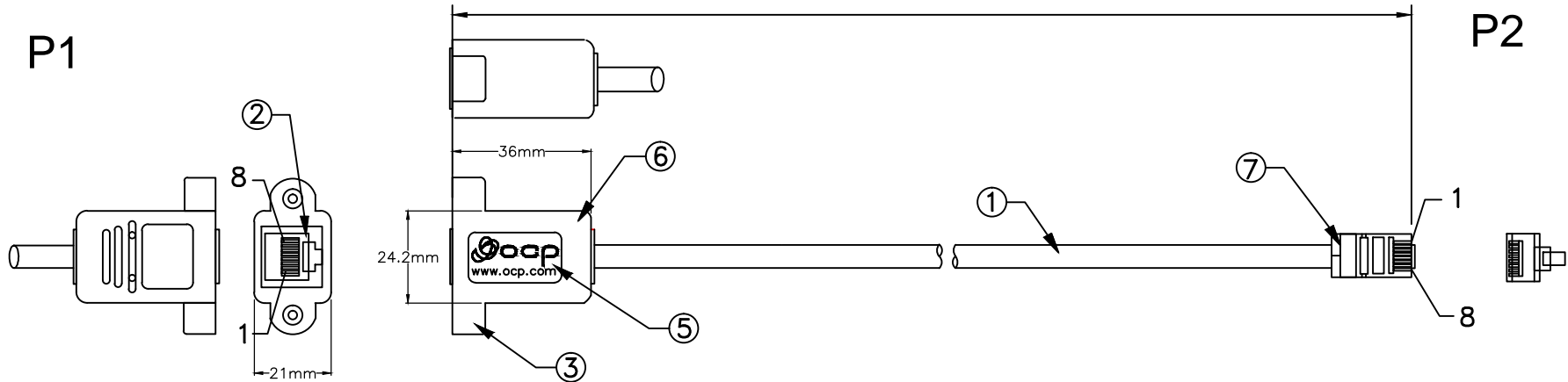

ITEM	DESCRIPTION/REMARKS	QTY
7	RJ45 8P8C PLUG, 50u" GOLD PLATED.	1
6	BLACK PVC, DUROMETER 90A.	
5	OCP LABEL	1
4	#4-40 SCREW	2
3	#4-40 NUT (BRASS)	2
2	RJ45 8P8C JACK, 50u" GOLD PLATED.	1
1	CAT.5E STP, 24AWG*4P, BLACK JACKET.	1

UNLESS OTHERWISE SPECIFIED
CABLE TOLERANCE

LENGTH +/- 3%

CONNECTOR TOLERANCE
.XXX± LINEAR
.XX± LINEAR



SCALE: NTS DATE: 03/03/11
UNITS: INCH CHK'D: CJG
DRAWN BY: DLG APP'D: CJG

TITLE:
CBL, CAT5e PANEL MOUNT
ETHERNET, SHIELDED

OCP PART NO.: 52-6600X-7

CUSTOMER: TBD

SIZE	DRAWING NUMBER:	REV	SHEET
A	52-6600X-7	A	1/1